

รายวิชา ภาษาอังกฤษ

รหัสวิชา อ23101

ชั้นมัธยมศึกษาปีที่ 3

ผู้สอน

ครูณงนุช จันทร์เสวก

เรื่อง

At the Airport

At the Airport



ขอขอบคุณภาพ Mohamed HassanTraveling.

จาก <https://pixabay.com/th/illustrations/แผนที่เที่ยวบินที่-วันหยุด-3953229/> (February 2, 2019)

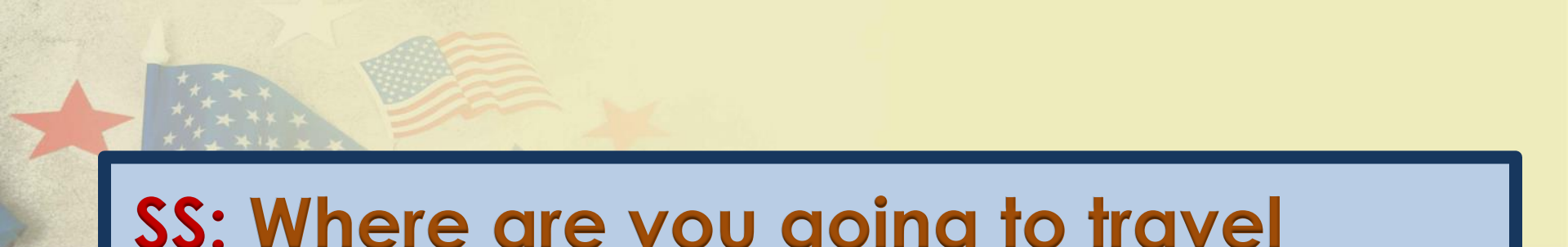

SS: Where are you going to travel
on your trip?

T: I'm going to travel to **Chiangmai**.

SS: How do you get to **Chiangmai** ?

T: By bus, train, airplane, car

What's your transportation



ขอขอบคุณภาพ Larisa Koshkina. Road.
จาก [https://pixabay.com/th/iphotos/ถนน-
ยางมะตอย-ท้องฟ้า-เมฆ-ตก-220058/](https://pixabay.com/th/iphotos/ถนน-
ยางมะตอย-ท้องฟ้า-เมฆ-ตก-220058/)
(November 28, 2013)

What's your transportation



ขอขอบคุณภาพ Larisa Koshkina. Road.
จาก <https://pixabay.com/th/iphotos/ถนน-ยางมะตอย-ท้องฟ้า-เมฆ-ตก-220058/>
(November 28, 2013)

What's your transportation



ขอขอบคุณภาพ Larisa Koshkina. Road.
จาก <https://pixabay.com/th/iphotos/ถนน-ยางมะตอย-ท้องฟ้า-เมฆ-ตก-220058/>
(November 28, 2013)

What's your transportation



ขอขอบคุณภาพ Martin Winkler. Railway.
จาก <https://pixabay.com/th/photos/รถไฟ-ทางรถไฟ-รถไฟ-สนิม-rail-1555348/>
(August 1, 2016)

At the Airport



Objectives

1. สามารถบอกความหมายของคำศัพท์เกี่ยวกับการเดินทางที่สนามบินได้
2. สามารถพูดสนทนาสั้น ๆ เกี่ยวกับสถานการณ์ในสนามบินได้

Vocabulary Station



ขอขอบคุณภาพ Mohamed HassanTraveling.

จาก <https://pixabay.com/th/illustrations/แผนที่-เที่ยวบินที่-วันหยุด-3953229/> (February 2, 2019)



Guess what is it



TICKET





Guess what is it



CABIN CREW





Guess what is it



OVERHEAD LOCKER





Guess what is it



RUNWAY





Guess what is it



BAGGAGE





Guess what is it



CUSTOMS





Guess what is it



TAKE OFF





Guess what is it



LAND





Guess what is it



CHECK IN





Guess what is it

?



DEPARTURE LOUNGE



Guess what is it

HAND LUGGAGE





Guess what is it

BAGGAGE CLAIM





Guess what is it

BOARDING CARD





Guess what is it



BOARDING PASS





Guess what is it

TERMINAL BUILDING





Guess what is it



EXCESS BAGGAGE



Matching



Exercise 25.1

Match the definitions
below with the correct
words.

Exercise 25.1



Report
the Airport
ตอนที่ 3

Name : _____ class _____ No _____

Directions: Match the definitions below with the correct words.

- | | |
|----------------------|---------------------------------|
| a. hand luggage | f. boarding card/ boarding pass |
| b. check-in desk | g. baggage reclaim |
| c. terminal building | h. departure lounge |
| d. excess baggage | i. cabin crew |
| e. runway | j. overhead locker |

1. _____ The place where you go when you arrive at the airport with your luggage.
2. _____ The card they give you with the seat number on it.
3. _____ The money you have to pay if your luggage is very heavy.
4. _____ The place where you sit and wait for your flight to be called.
5. _____ The bags you carry onto the plane with you.
6. _____ The place above your head where you can put your hand luggage.
7. _____ The part of the airport where the plane takes off.
8. _____ The people who look after you on the plane.
9. _____ The part of the airport where you go when you depart or land.
10. _____ The place where you collect your luggage after you land.



ขอขอบคุณภาพ Mabel Amber. Key.

จาก <https://pixabay.com/th/photos/ที่สำคัญ-โลหะ-ประตูทางเข้า-ประตู-1600617/> (August 19, 2016)

Exercise 25.1

1. The place where you go when you arrive at the airport with your luggage.

b) check-in desk



ขอขอบคุณภาพ Mattes. Check in desk.

จาก https://en.wikipedia.org/wiki/Airport_check-in#/media/File:VTBS-Thai_Check-In-Counters.JPG
(January 31, 2017)

Exercise 25.1

2. The card they give you with the seat number on it.

f) boarding card/
boarding pass

LIN [REDACTED]		ZONE 2	
PREMIUM ECONOMY/ECONOMIQUE PRIVILEGE ETKT014		Frequent Flyer/Voyageur assidu NH*	Cabin/Cabine 0
Flight/Vol AC 011	Date 14AUG/AOU	From/De VANCOUVER	Destination TAIPEI
Boarding Time/Heure d'embarquement 10:25		Gate/Porte 65	Seat/Place 13H
Departure Time/Heure de depart 11:10		Remarks/Observations 13H AISLE/COULOIR 66	
Airline Use/A usage interne [REDACTED]		AIR CANADA	
Boarding Pass Carte d'accès à bord		A STAR ALLIANCE MEMBER MEMBRE DU RESEAU STAR ALLIANCE	

Exercise 25.1

3. The money you have to pay
if your luggage is very heavy.

d) excess baggage



Exercise 25.1



4. The place where you sit and wait for your flight to be called.

h) departure lounge

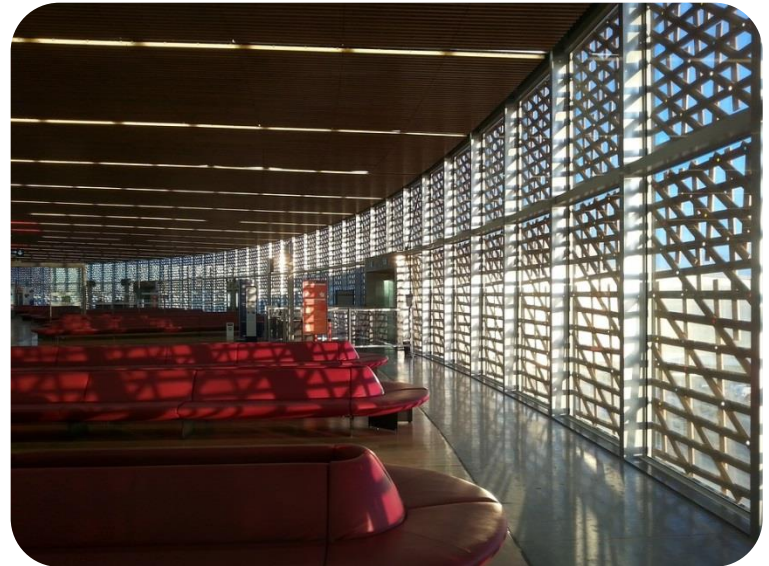

ขอขอบคุณภาพ Jedgell. Departure lounge

จาก <https://pixabay.com/photos/สนามบิน-ชั่ว-ออกเดินทาง-ร้าง-2016897/>

(August 5, 2016)

Exercise 25.1

5. The bags you carry onto the plane with you.

a) hand luggage



Exercise 25.1

6. The place above your head where you can put your hand luggage.

j) overhead locker



Exercise 25.1



7. The part of the airport where the plane takes off.

e) runway



Exercise 25.1



8. The people who look after you
on the plane.

i) cabin crew



Exercise 25.1



9. The part of the airport where you go when you depart or land.

c) terminal building



Exercise 25.1

10. The place where you collect your luggage after you land.

g) baggage reclaim



Completing the sentences



Exercise 25.2

Use the words given
below to complete the
following sentences.



ใบงานที่ 25.2 เรื่อง At the Airport พจนานุกรม Exercise 25.2

At the Airport
นักศึกษาปีที่ 3

Name : _____ class _____ No _____

Directions: Use the words given below to complete the following sentences.

lands	cabin crew	overhead locker
passport	baggage	takes off
customs	check in	departure lounge
hand luggage	duty-free	baggage claim
to board	ticket	runway

1. When you travel by plane you usually have to _____ an hour before your flight.
2. First you go to the check-in desk where your _____ will be checked and your baggage weighed.
3. If you have excess _____ it can be expensive.
4. A light bag is classed as _____ and you can take it on the plane with you.
5. Your _____ will also be checked and then you can go through to the _____ to wait for your flight.
6. You can buy some _____ goods while you're waiting for your plane.
7. On the plane there is an _____ where you can put your hand luggage.
8. After a few minutes the plane _____ and the _____ will look after you.
9. When you arrive at your destination the plane _____ on the _____ and you get off.
10. You then have to go through _____ before moving on to the _____ to find your luggage.



Exercise 25.2

1. When you travel by plane you usually have to check in an hour before your flight.



Exercise 25.2

2. First you go to the check-in desk where your passport will be checked and your baggage weighed.



Exercise 25.2

3. If you have excess baggage
it can be expensive.



Exercise 25.2

4. A light bag is classed as hand luggage
and you can take it on the plane with you.



Exercise 25.2

5. Your ticket will also be checked
and then you can go through to
the departure lounge to wait for your flight.



Exercise 25.2

6. You can buy some duty-free goods while you're waiting for your plane.



Exercise 25.2

7. On the plane there is an overhead locker where you can put your hand luggage.



Exercise 25.2

8. After a few minutes the plane takes off
and the cabin crew will look after you.



Exercise 25.2

9. When you arrive at your destination
the plane lands on the runway
and you get off.



Exercise 25.2

10. You then have to go through
customs before moving on to
the baggage reclaim to find your luggage.

QUOTE OF THE DAY

*Life is short
and the world is wide.*



ขอขอบคุณภาพ Bilal EL-Daou. Plane.

จาก <https://pixabay.com/th/photos/บริษัท-สายการบิน-ท้องฟ้า-2721333/> (September 6, 2017)