

# รายวิชา ภาษาอังกฤษ

รหัสวิชา อ16101

ชั้นประถมศึกษาปีที่ 6

## เรื่อง *How Can I Get to the Canteen? (1)*

ครูผู้สอน ครูนกวรรณ มีศรีผ่อง



# How Can I Get to the Canteen? (1)



# Objectives

The students are able to

pronounce the words correctly.

read the sentences correctly.

give and ask directions properly.



**Let's learn new words!**

## **Giving Directions**

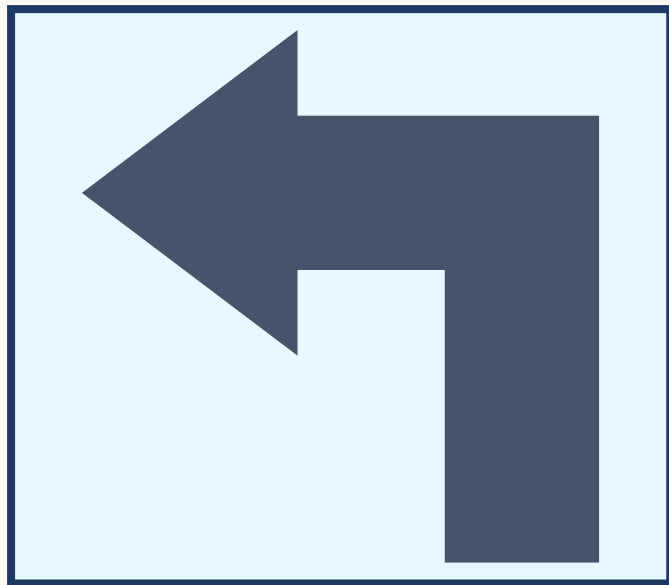

**turn left**

**turn right**

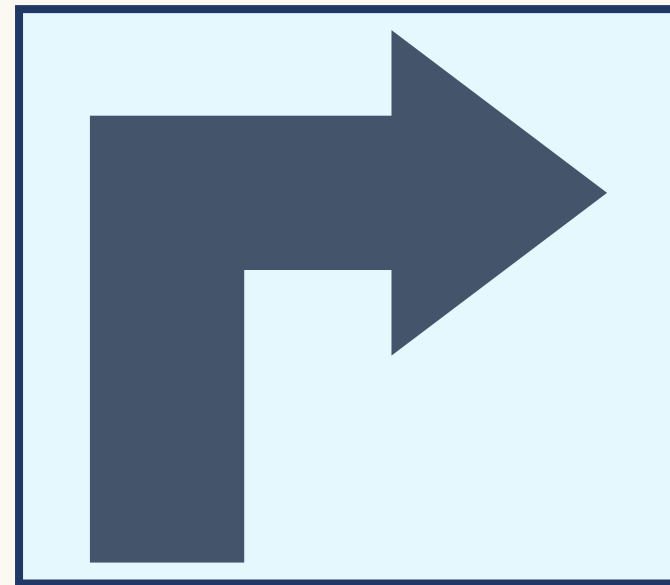

# Giving Directions

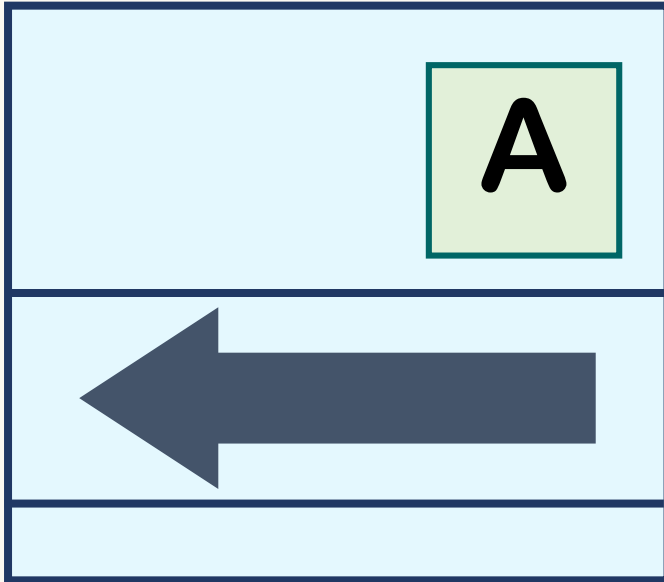

**go pass**

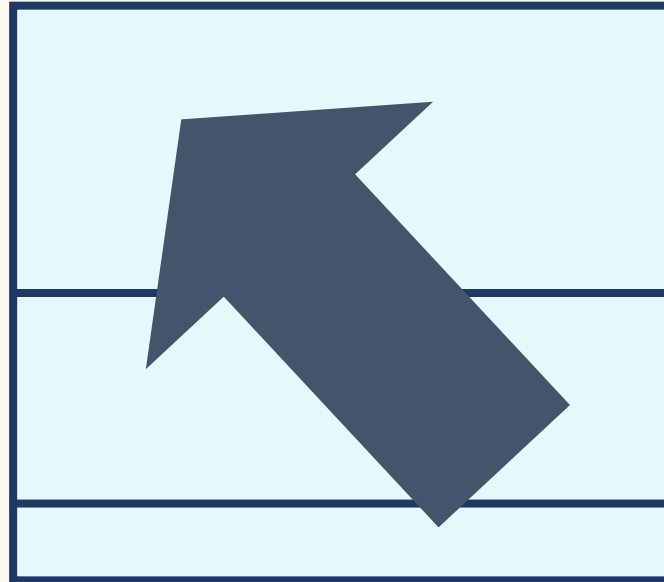

**go straight  
ahead**

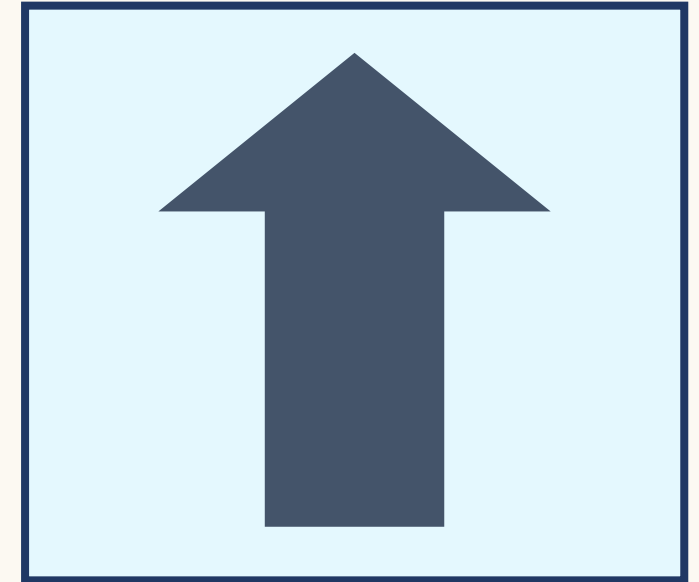

**cross**

# Giving Directions

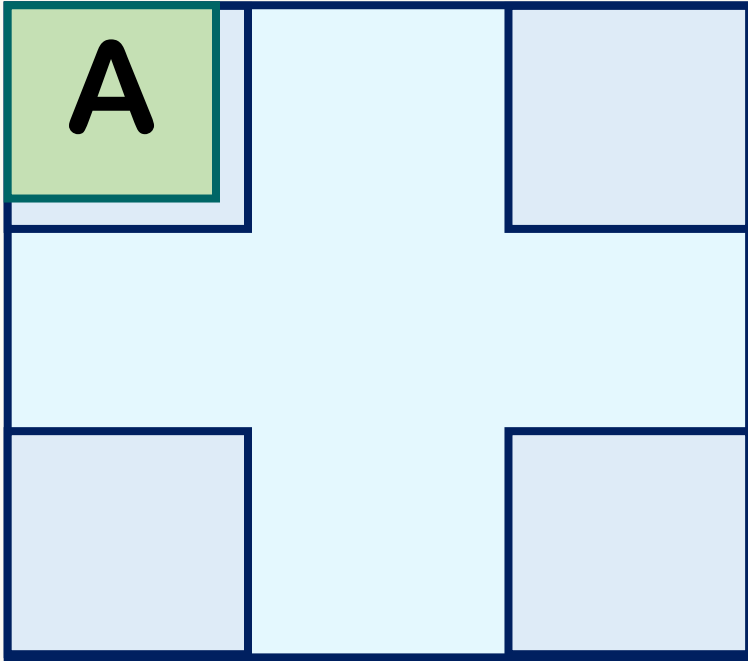

next to

at the  
corner of

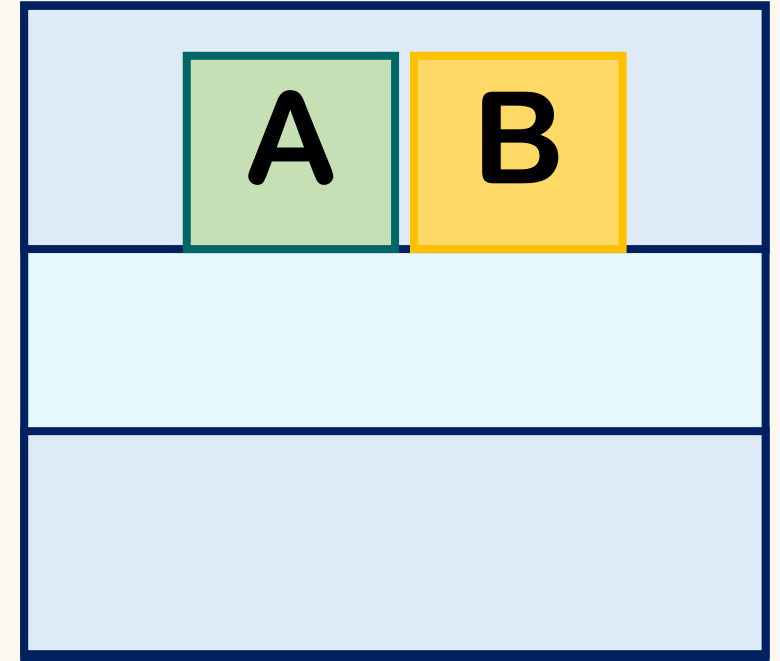

# Giving Directions

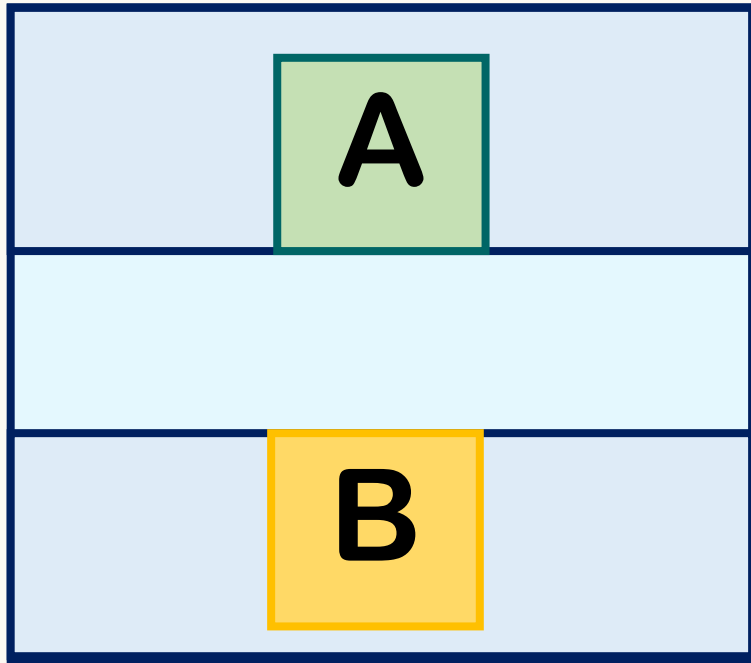

opposite to

between

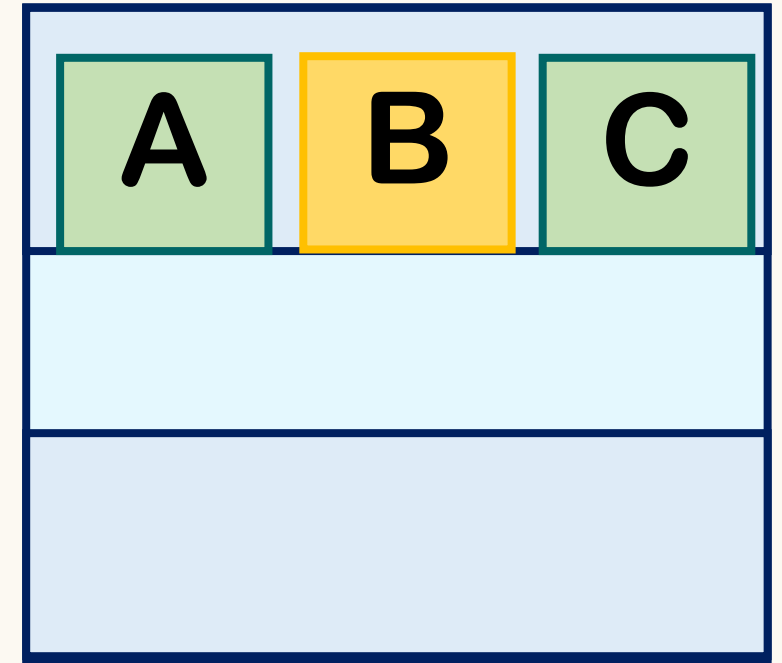

# WORKSHEET 1: Name the Places

Instructions: Look at the school map and name the places.

## Part A

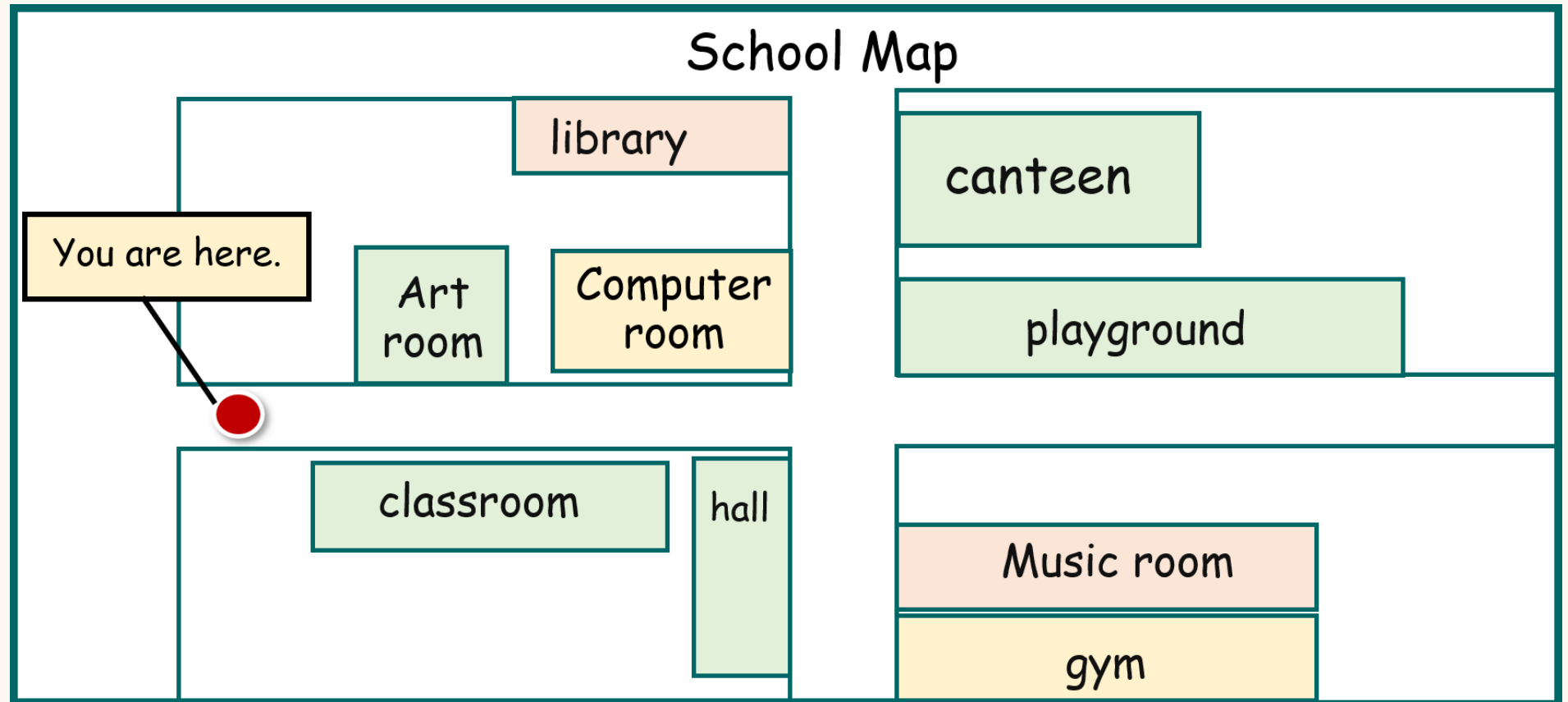



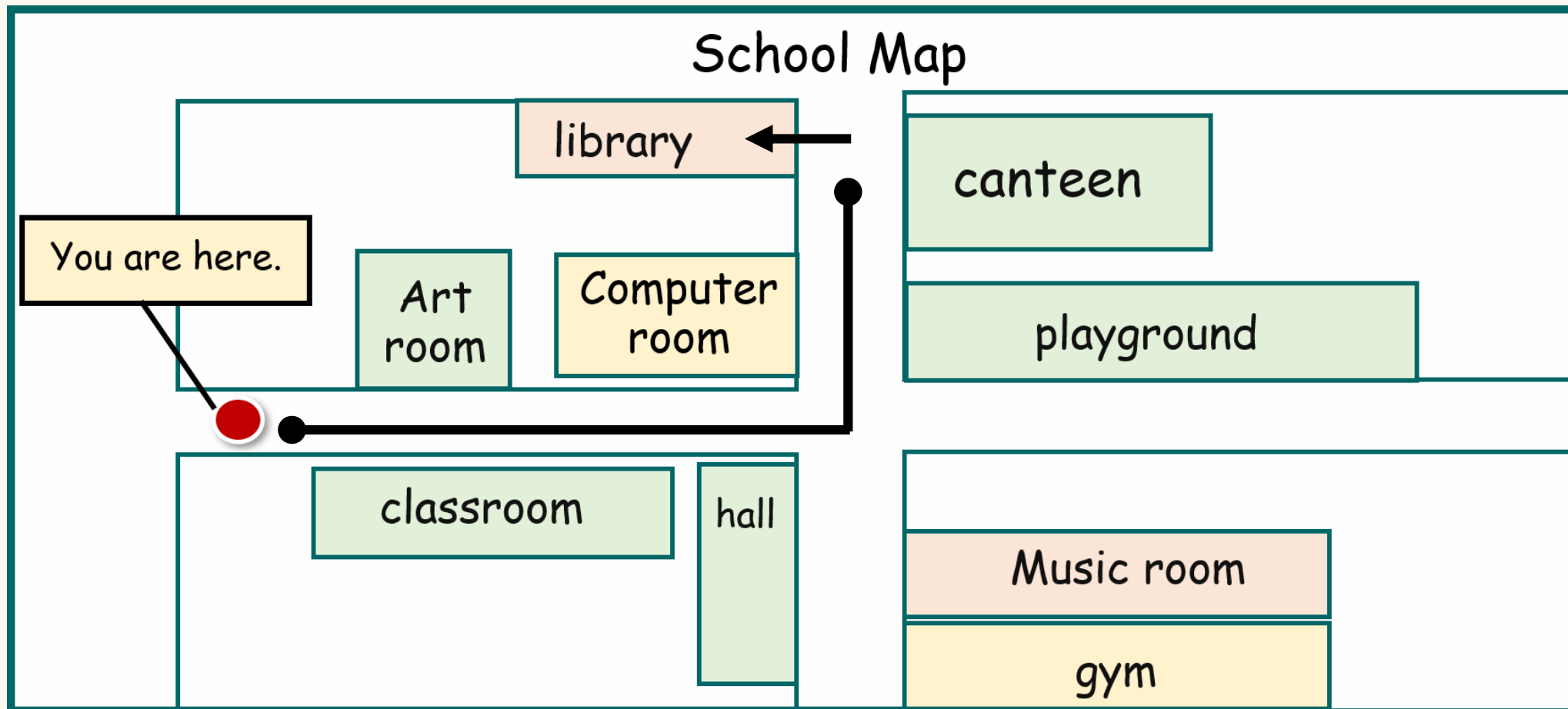

1. Walk along the road. Turn left. It's on the left, opposite the canteen.

**library**

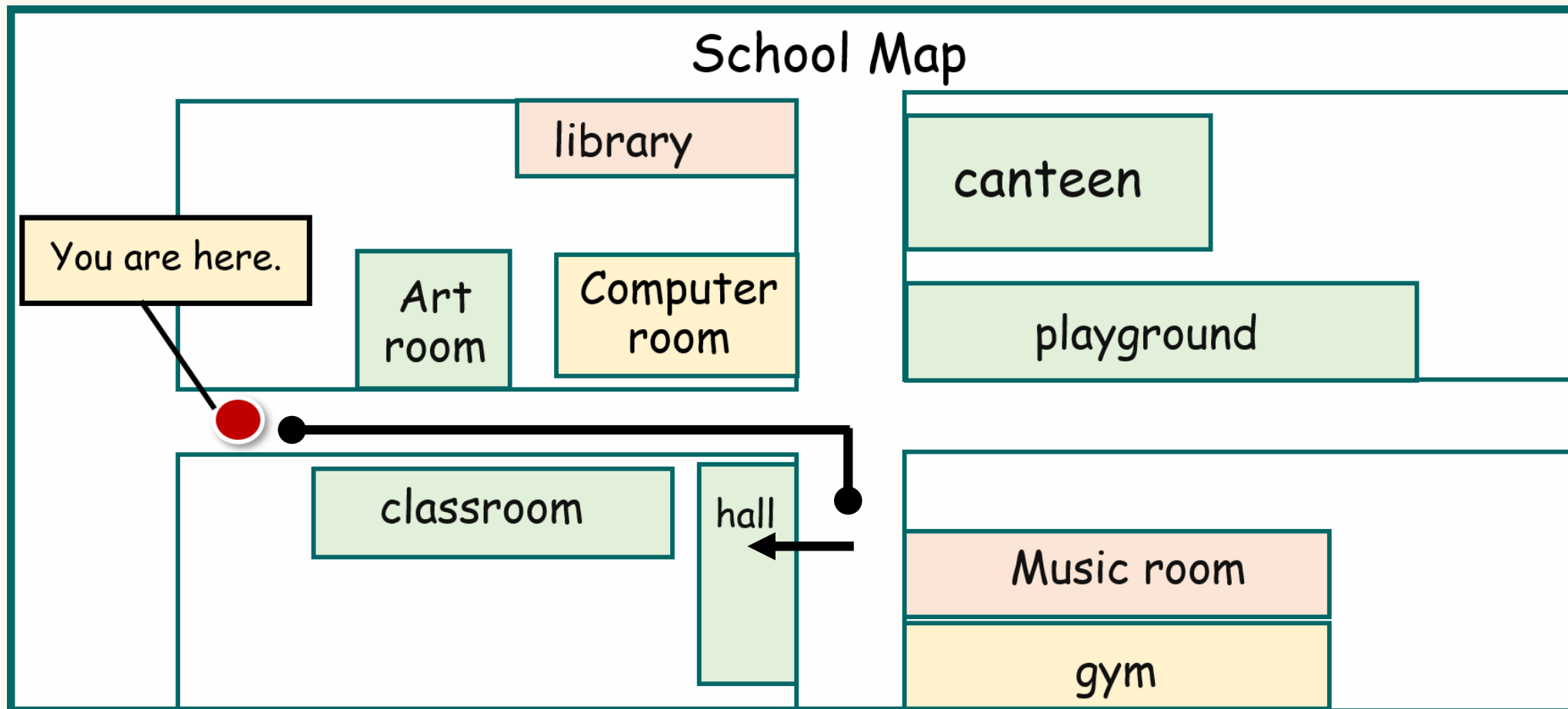

2. Walk along the road. Turn right.  
It's on the corner.

hall

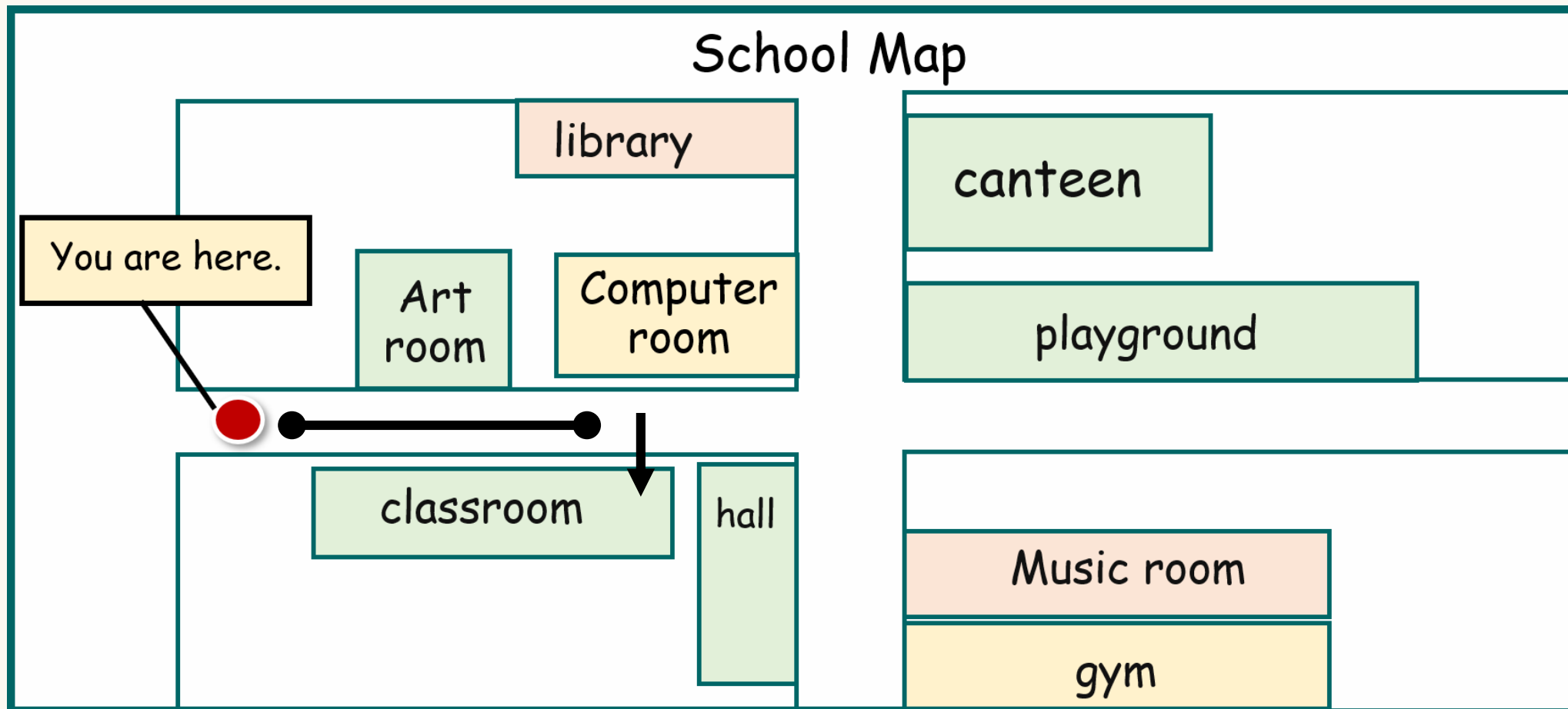

3. Go straight on. It's on your right, near the hall.

**classroom**

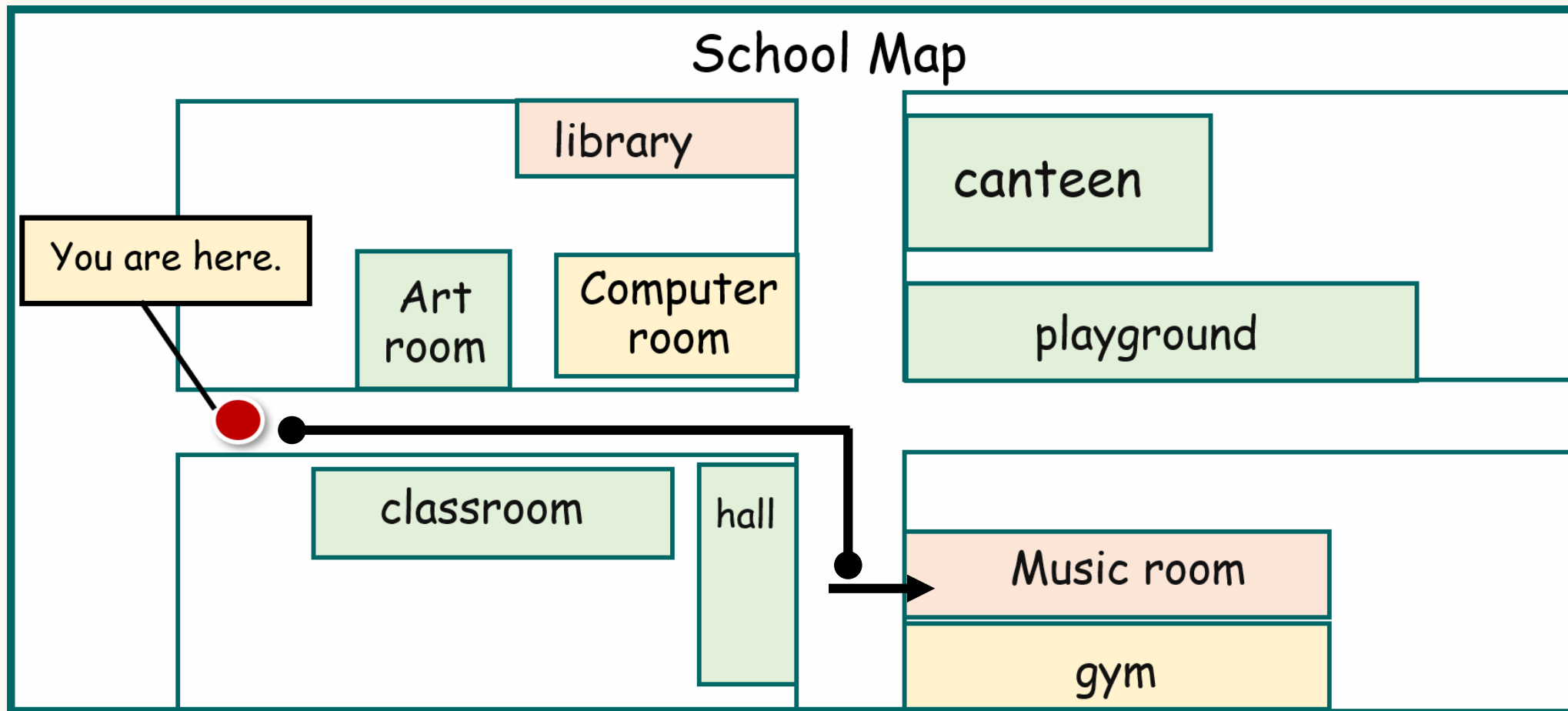

4. Walk along the road. Turn right. It's on the left, next to the gym.

**Music Room**

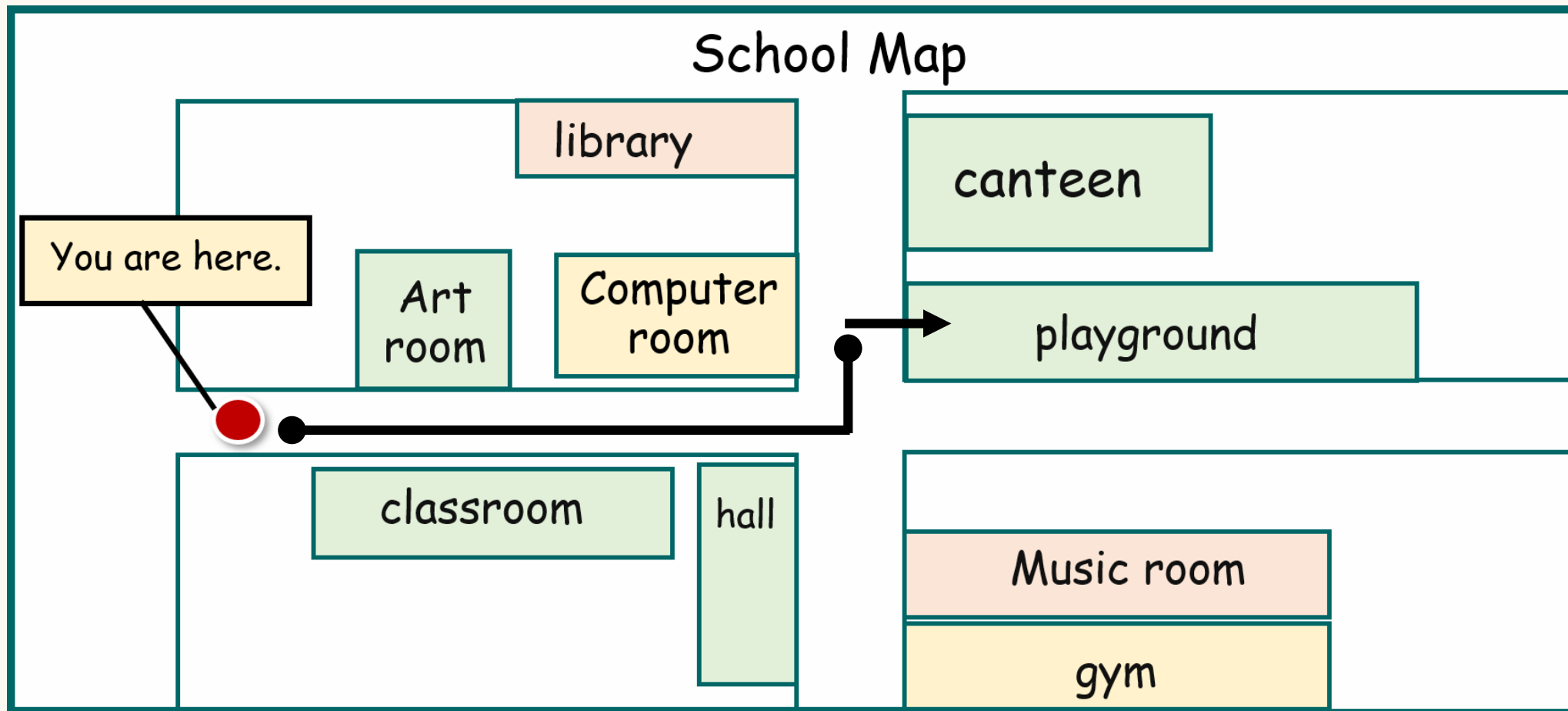

5. Walk along the road. Turn left. It's on the right, opposite to the computer room.

**playground**

# Giving Directions

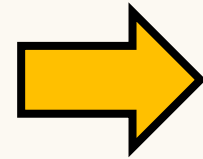
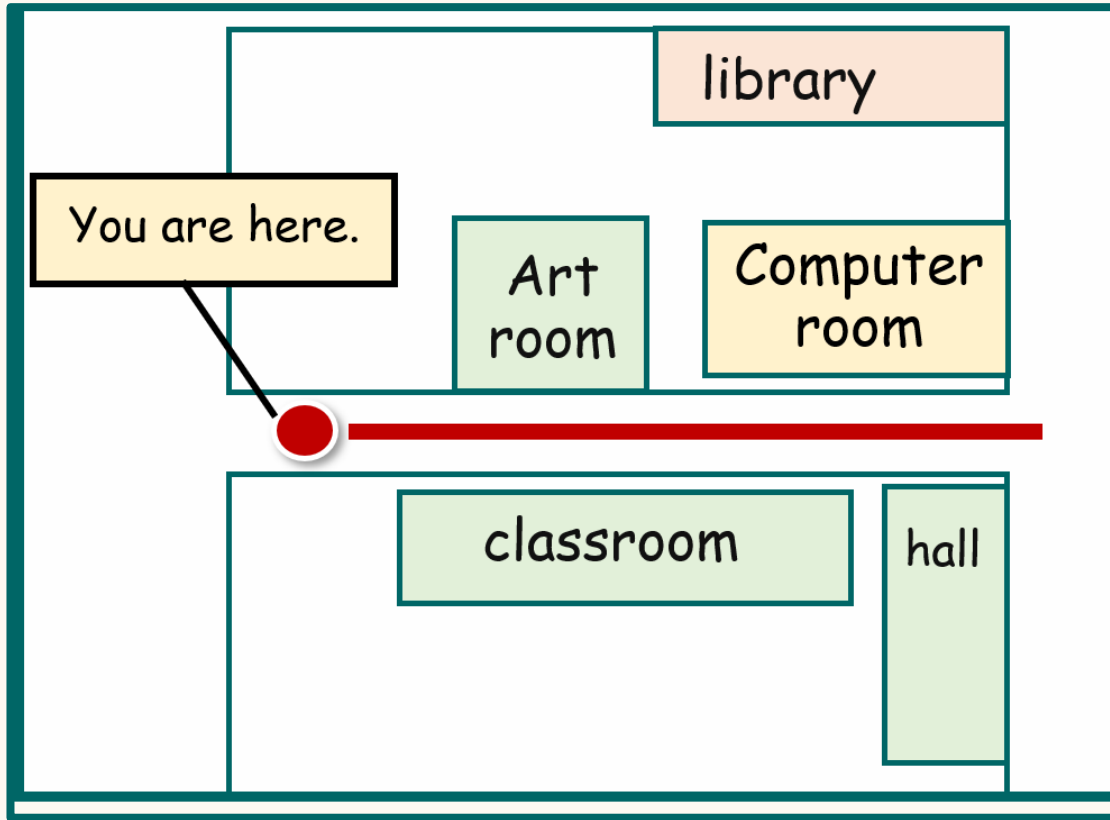

Walk along the road.  
Walk along the street.  
Go straight on.  
Go straight ahead

# Giving Directions

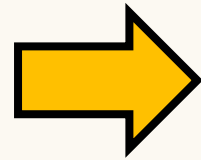
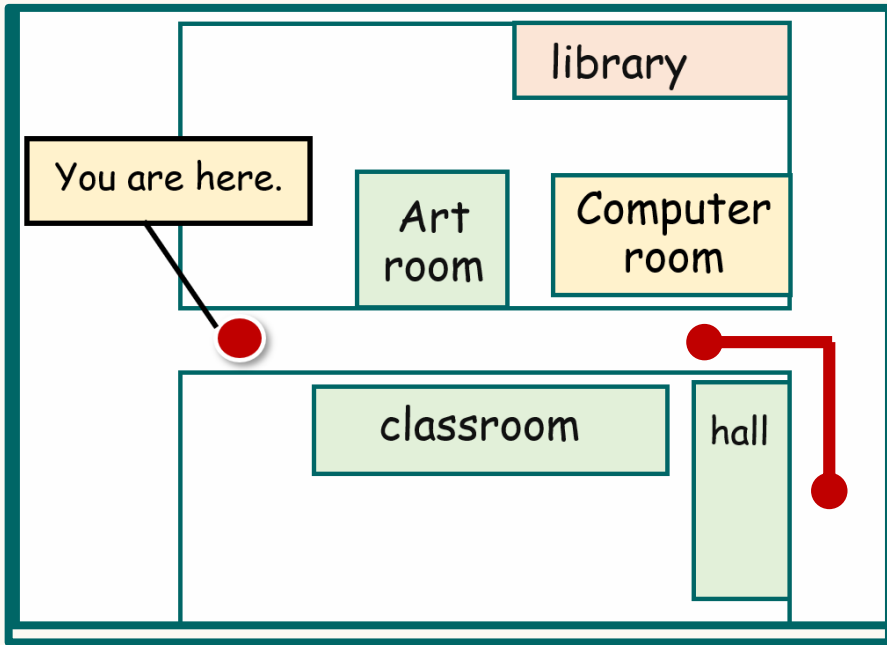

Turn right.

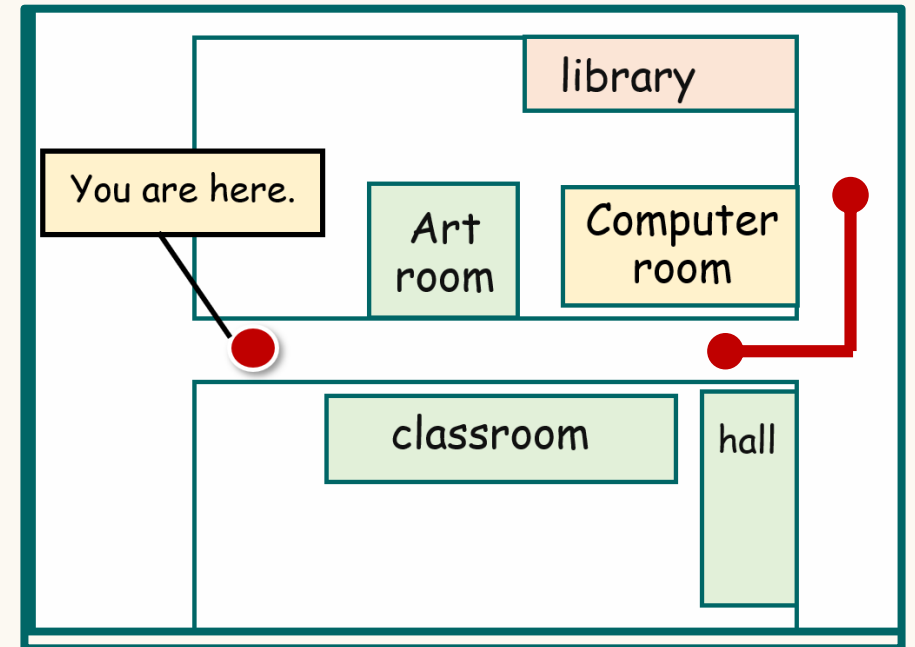

Turn left.

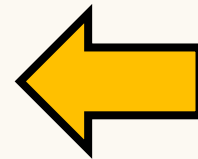

# Let's practice!

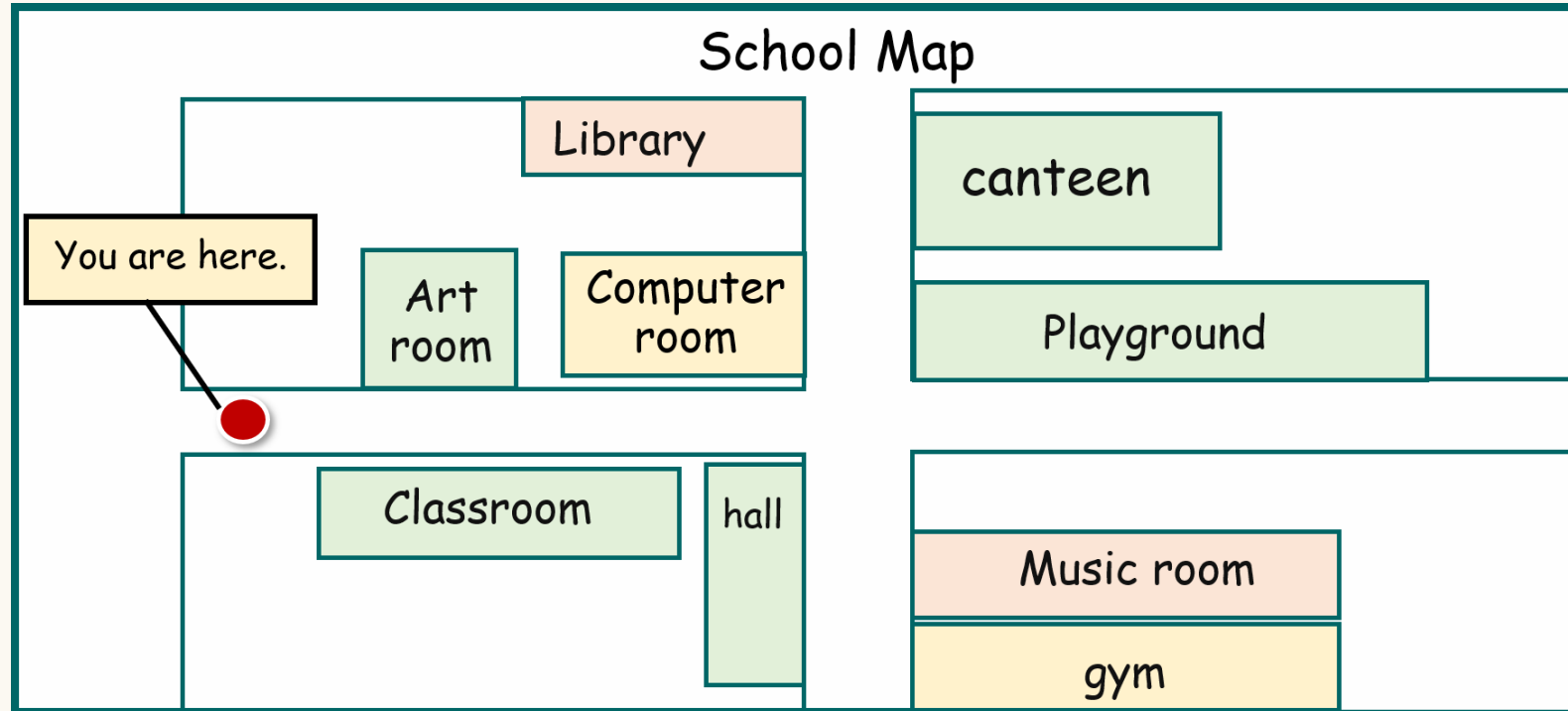

Where is the **classroom**?

It's **near** the **hall**.





# Let's practice!

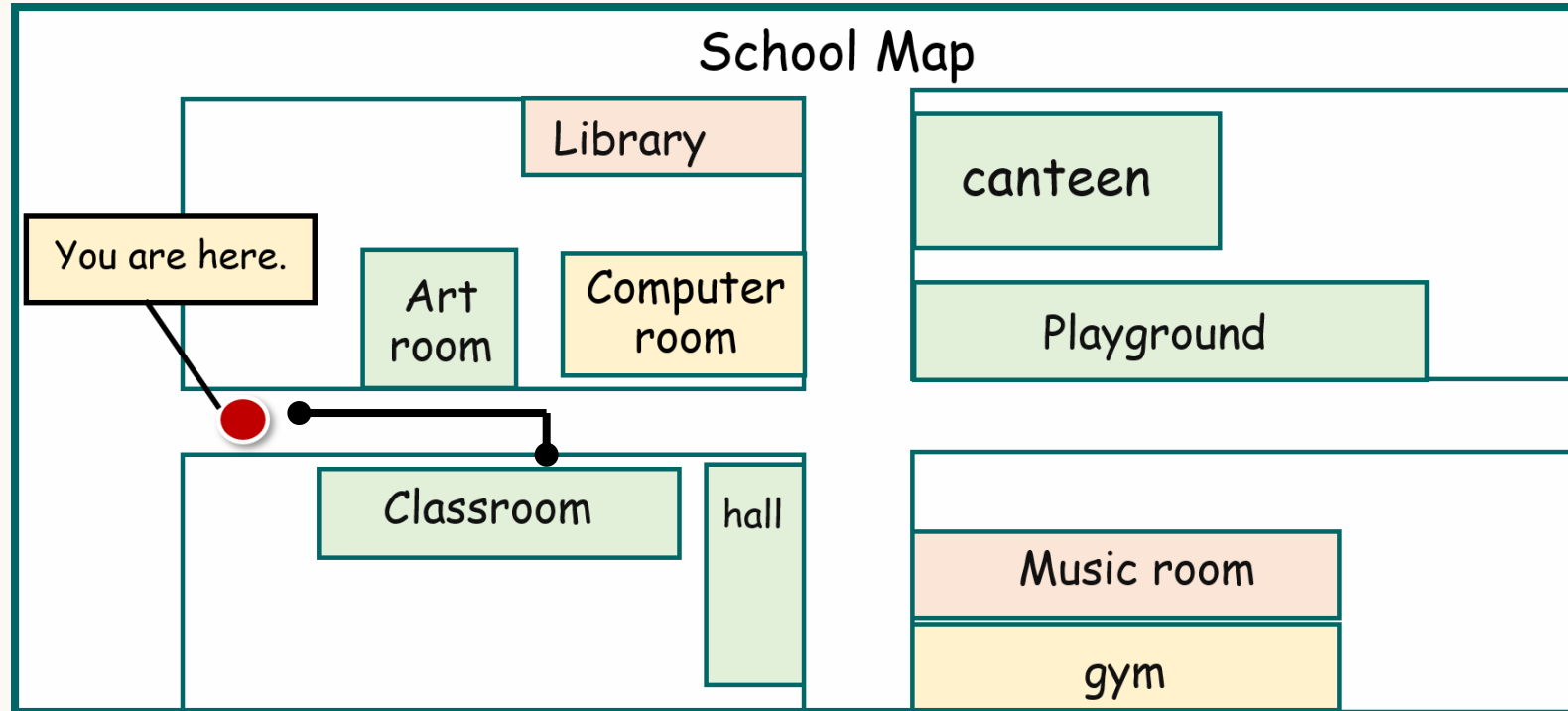

How can I get to the classroom?

Walk along the road. It's on the right,  
near the hall.



# WORKSHEET 2: How Can I Get to School?

Instructions: A) Look at the map and complete the dialogues.

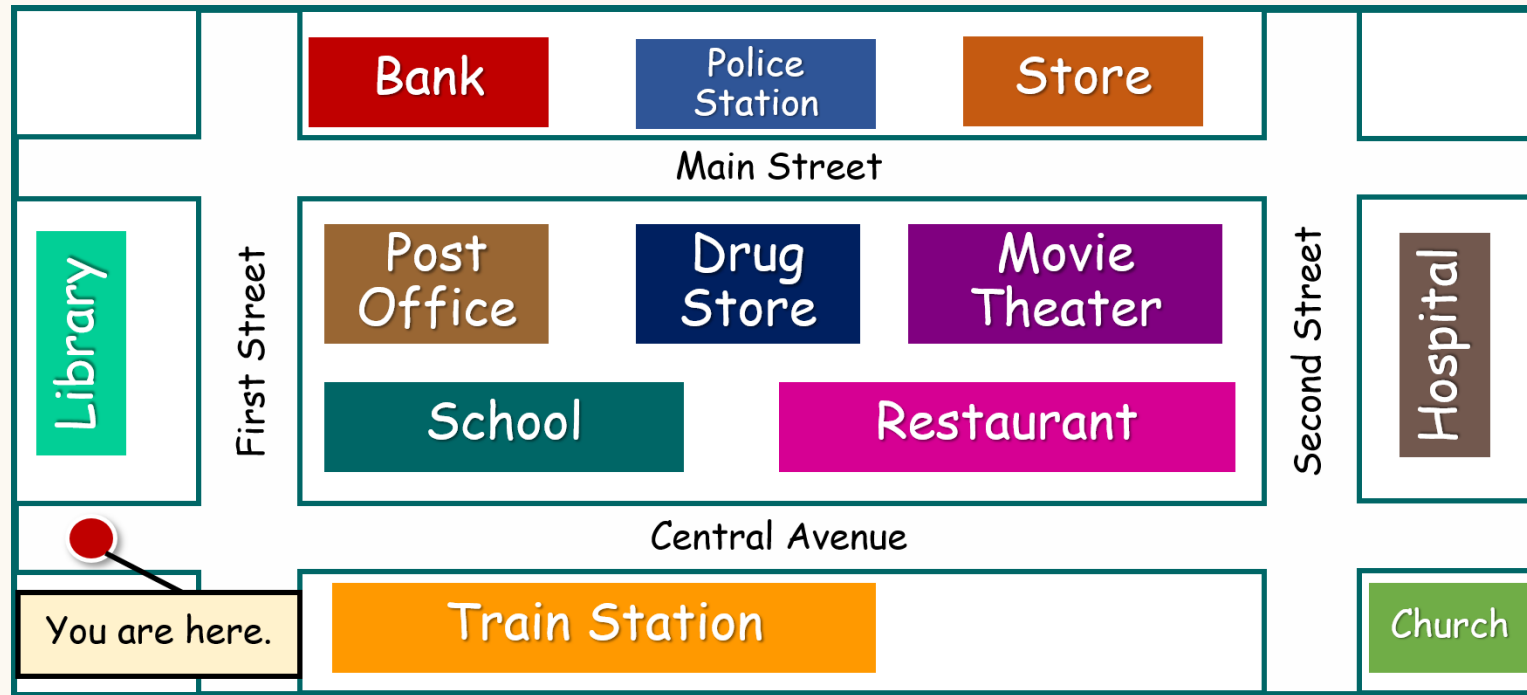

turn right  
on the corner

your left  
on

opposite to  
straight

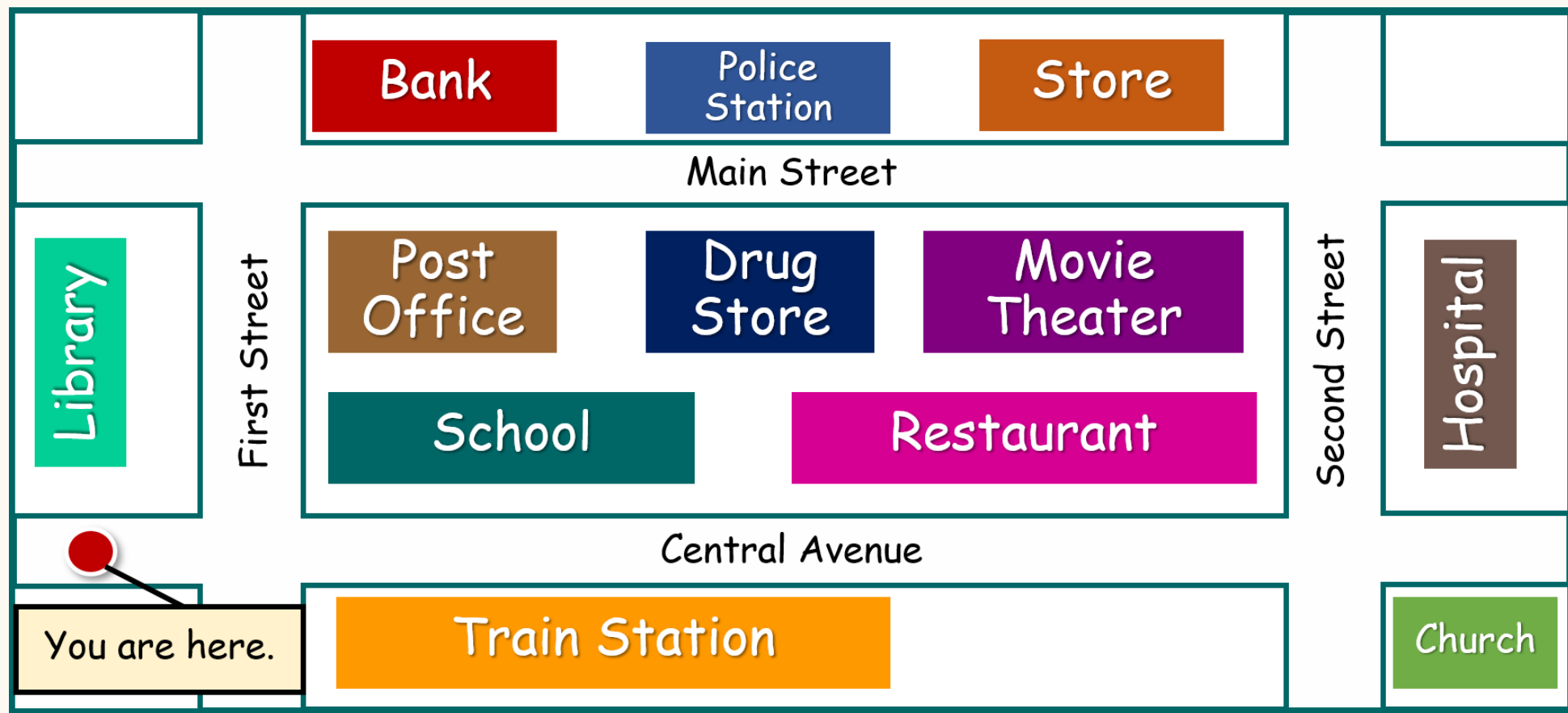

turn right / your left / opposite to / on the corner / on / straight

A: Excuse me. Where is the school?

B: It's on Central Avenue, opposite to the train station.

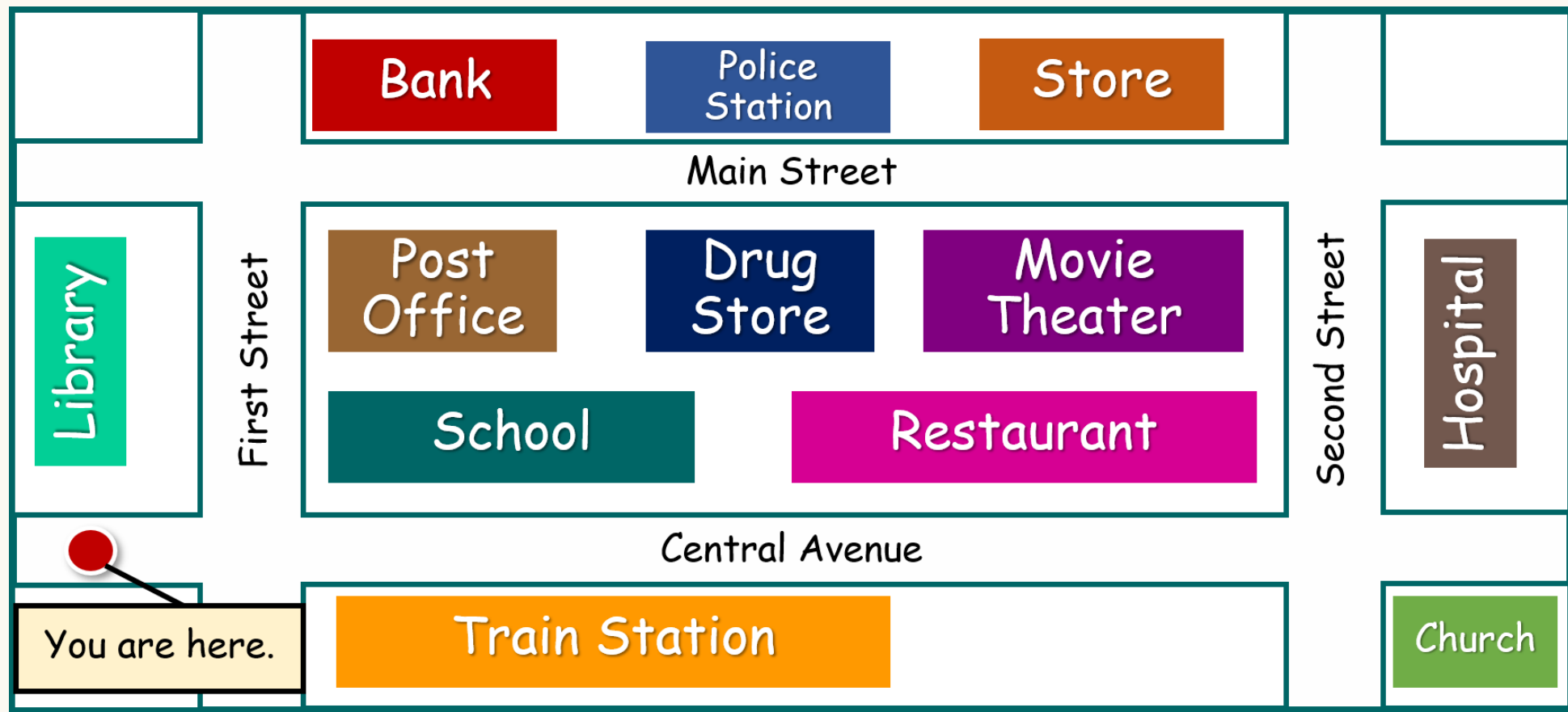

turn right / your left / opposite to / on the corner / on / straight

A: How can I get there?

B: Go straight on. It's on your left.

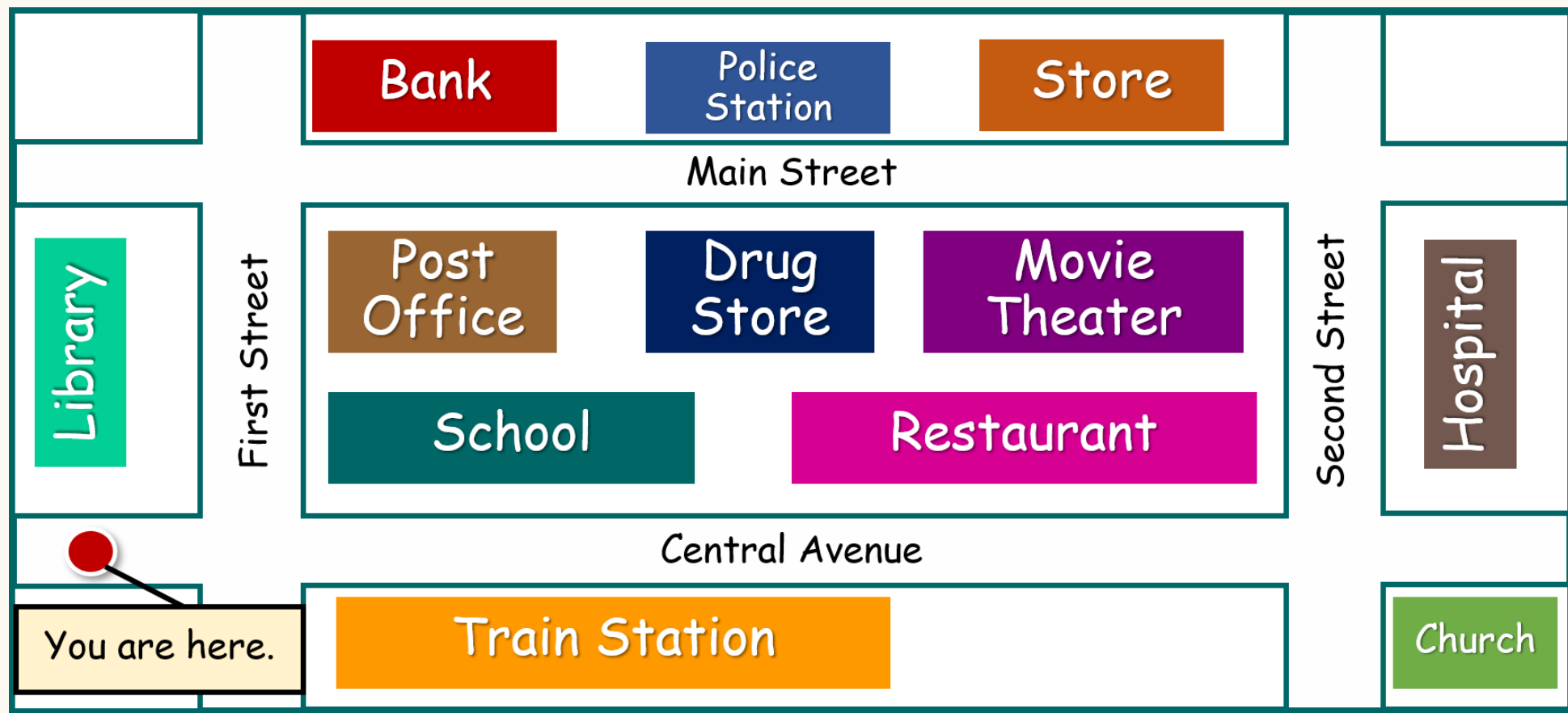

turn right / your left / opposite to / on the corner / on / straight

A: And how can I go to the bank?

B: Walk along First Street. Then turn right.

It is on the corner of First Street and Main Street.

# Rearrange the dialogue.

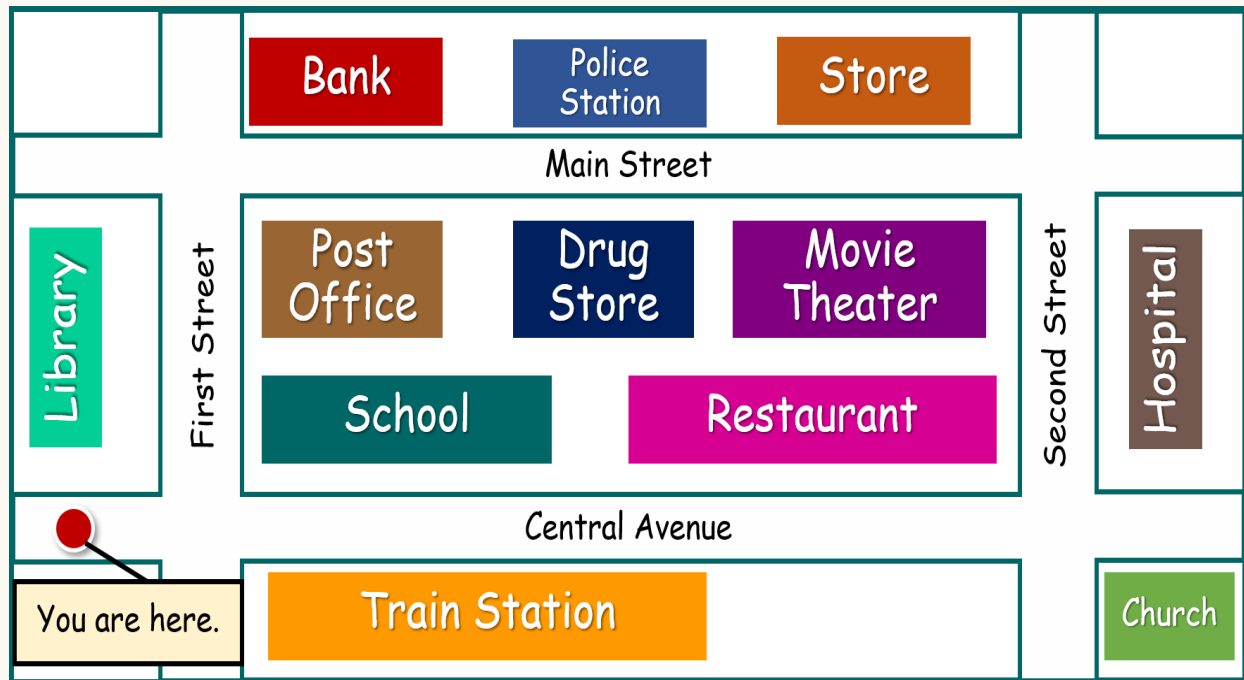

4 B: Walk along Main Street. It's on your left, between the bank and the store.

3 A: How can I get there?

1 A: Excuse me. Where is the **police station**?

2 B: It's on Main Street ,near the bank.

Instructions: B) Make your own dialogue.

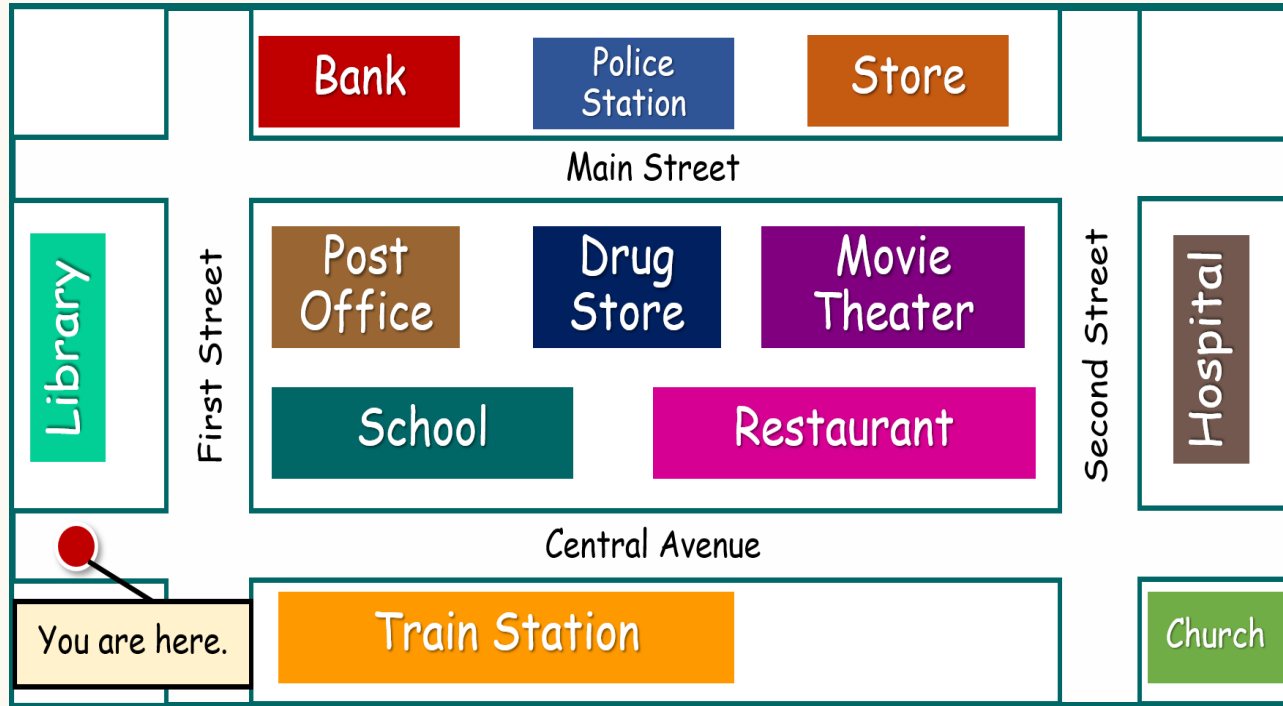

A: Excuse me. Where is the **police station**?

B: It's on Main Street, near the bank.

A: How can I get there?

B: Walk along Main Street. It's on your left, between the bank and the store.

# REVIEW

A: Excuse me. Where is the police station?

It's **on** Main Street , **near** the bank.

A: How can I get to the police station?

**Walk along** Main Street. It's **on your left**,  
**between** the bank and the store.



# REVIEW

Look at the map above. Tell the directions.

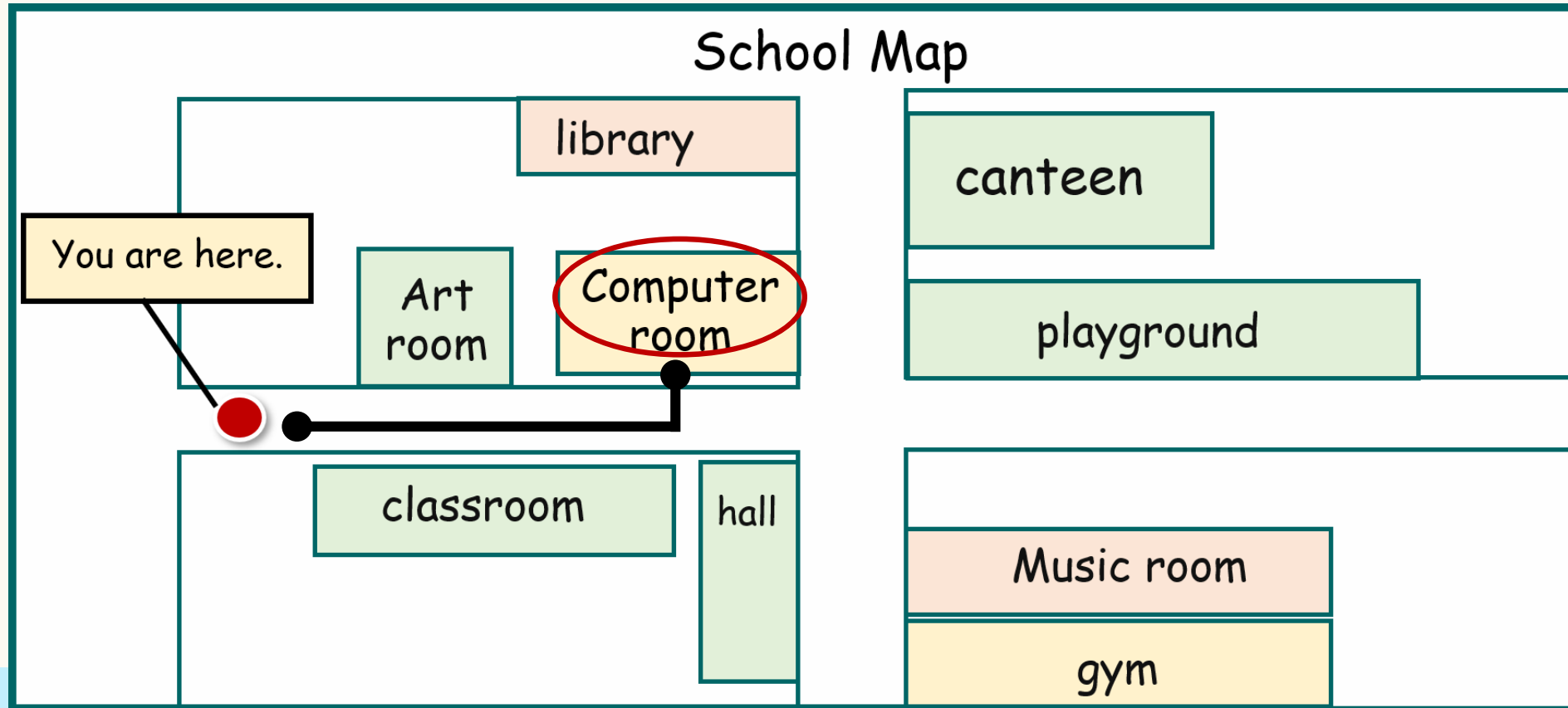

Go past the Art room.  
It's on your left ,on the corner.

## ใบงานที่ 1 Name the Places

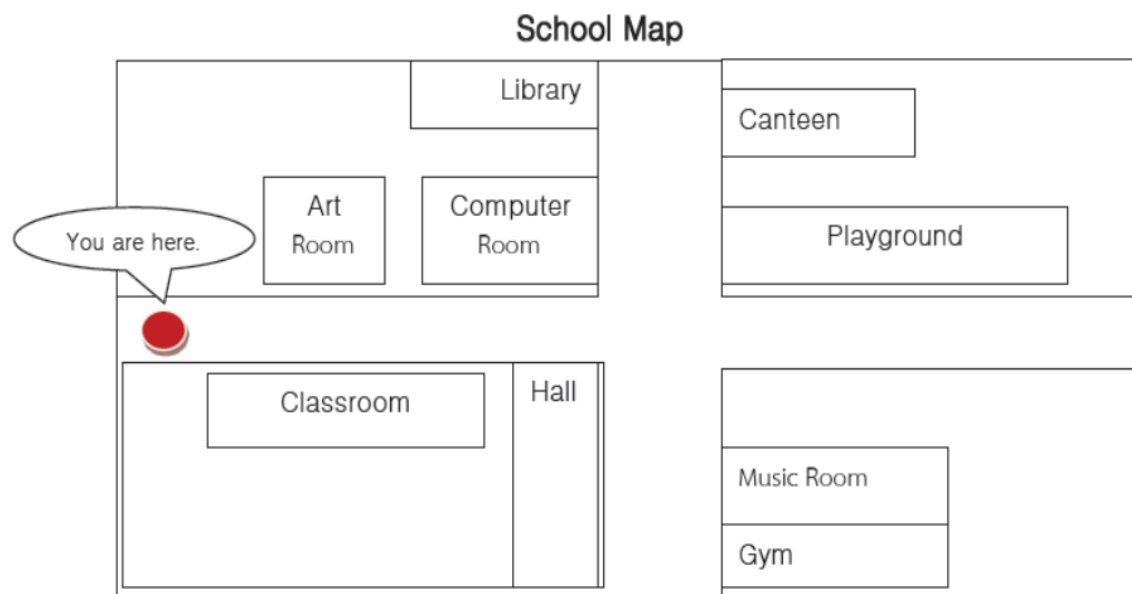

**Part B: Look at the map above. Then ask and answer with your partner.**

A: Go straight on. It's on the corner, near the canteen.

B: The playground.

A: Go straight ahead. Turn left. It's opposite the canteen.

B: The library.

# Assignments

## WORKSHEET 1

**Part B:** Ask and answer  
with your partner

## ใบงานที่ 2 How Can I Get to School?

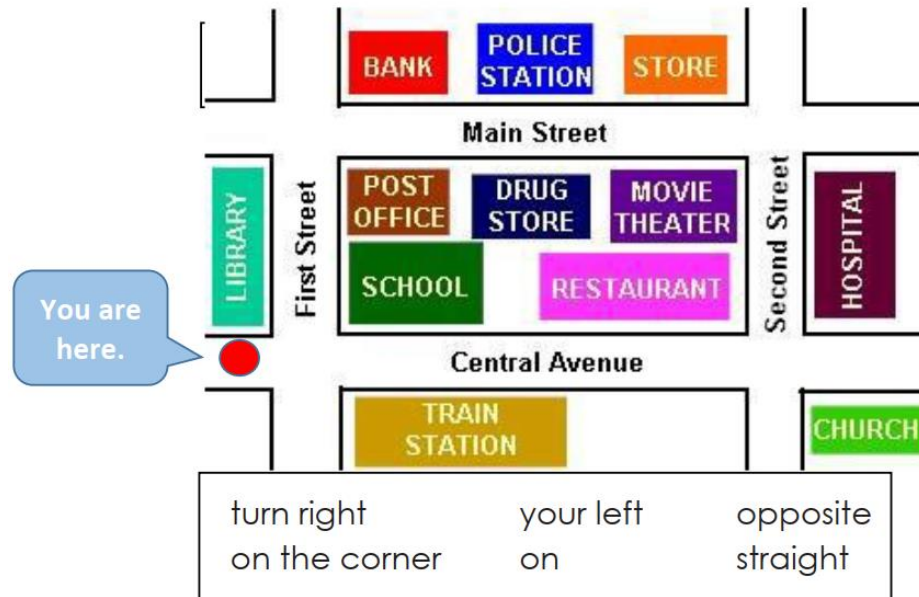

B) Make your own dialogue. เขียนบทสนทนา

S1: \_\_\_\_\_ S1: \_\_\_\_\_

S2: \_\_\_\_\_ S2: \_\_\_\_\_

S1: \_\_\_\_\_

S2: \_\_\_\_\_

# Assignments

## WORKSHEET 2

### Part B: Make your own dialogue.